

Oil filter boss on engine block

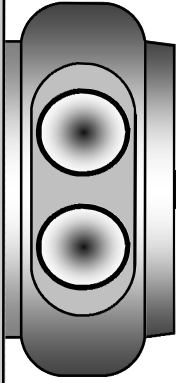

Oil filter boss on engine block

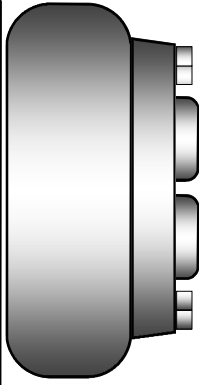

Take-off plate fits to oil filter boss (in place of oil filter) and provides in/out oil line ports for remote oil filter and/or optional oil cooler. Please view the Remote Oil Cooler file for details.

Take-off plates are available in two basic designs.

The above shows a "side" take-off plate, this can be rotated to any angle in order to avoid oil lines fouling exhausts, steering etc. The diagram at left shows a take-off plate where the ports face downwards.

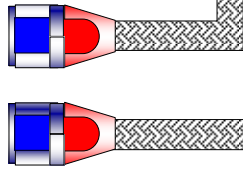
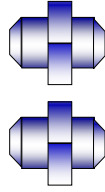

A full range of angled hose ends are available to assist in the routing of hose lines.

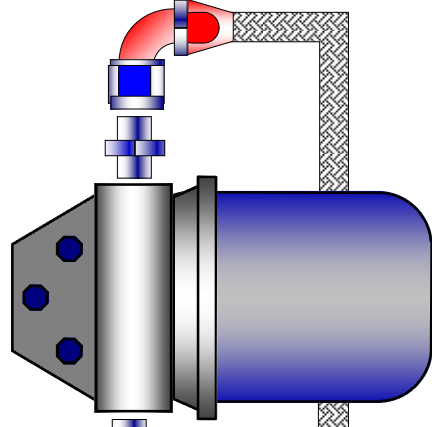

## Generic design for fitting a remote oil filter.

Remotely locating the oil filter gives greater space for fitting competition exhaust systems, easier filter access, access to bigger and better filters and the ability to locate the filter away from destructive heat sources.

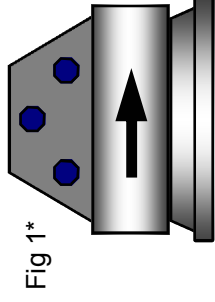

Fig 1\*

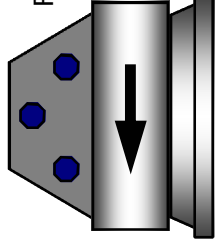

Fig 2\*

Remote filter heads are available in left-to-right oil flow (fig 1), right-to-left flow (fig 2), both in and out ports on the left side (fig 3), or both on top (fig 4). (\* Temp gauge boss optional)

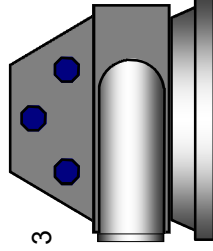

Fig 3

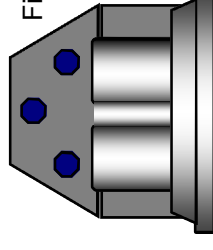

Fig 4



[www.speedflow.co.uk](http://www.speedflow.co.uk)

tel: 0870 225 0097

© speedflow products limited 2007